

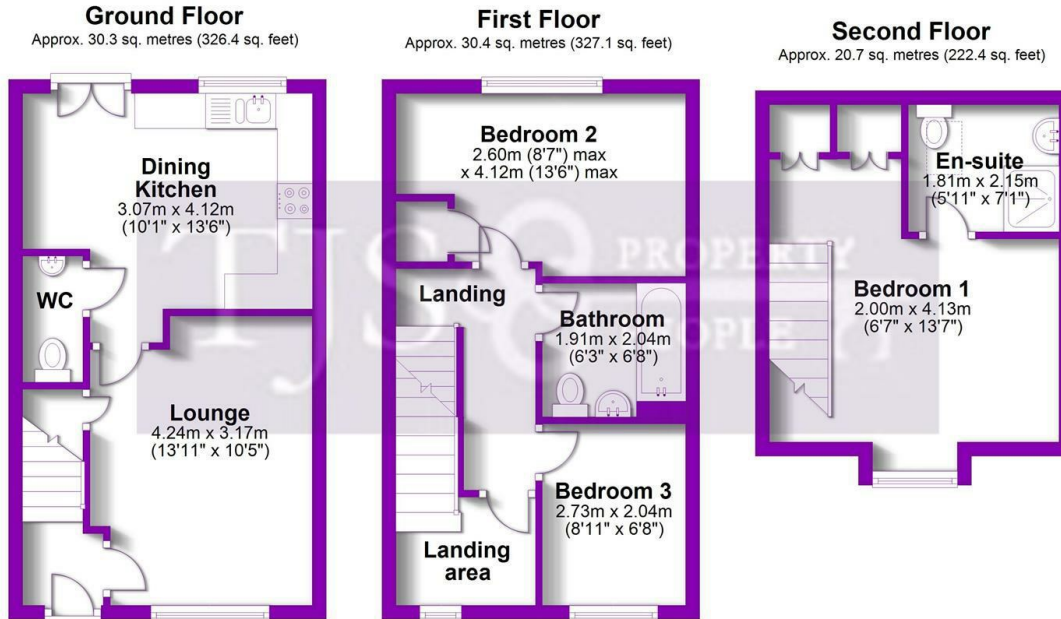

## 14 Hickling Close, Nottingham, NG10 3TE

£1,200 Per month

- 3 bedroom mid terraced house
- Double glazed throughout
- Family bathroom to first floor
- EPC Rating = C
- Neutral décor and carpets
- Kitchen area with integrated cooking facilities
- Master bedroom with en-suite
- Gas central heating system and combi boiler
- Downstairs WC
- Excellent public transport links to Derby & Nottingham



Total area: approx. 81.4 sq. metres (875.9 sq. feet)

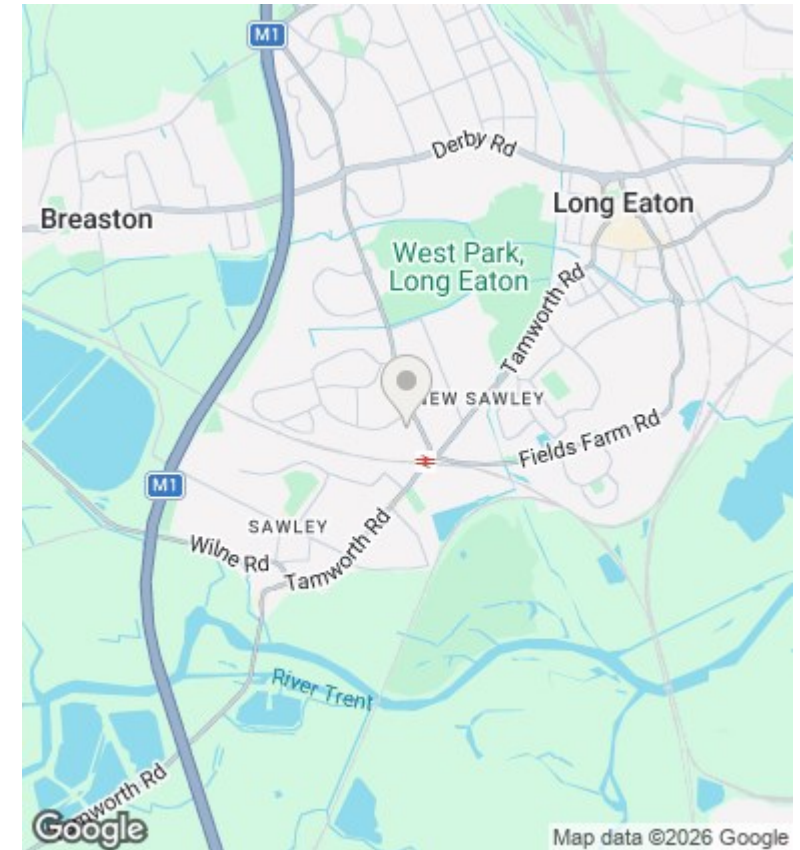

## Directions

## Viewings

Viewings by arrangement only. Call 0115 6713038 to make an appointment.

## Council Tax Band

C

## EPC Rating:

C

Energy Efficiency Rating		
	Current	Potential
Very energy efficient - lower running costs		
(92 plus) <b>A</b>		<b>90</b>
(81-91) <b>B</b>		
(69-80) <b>C</b>	<b>78</b>	
(55-68) <b>D</b>		
(39-54) <b>E</b>		
(21-38) <b>F</b>		
(1-20) <b>G</b>		
Not energy efficient - higher running costs		
<b>England &amp; Wales</b>	EU Directive 2002/91/EC	